

ACTC Approved Sidecar Specification

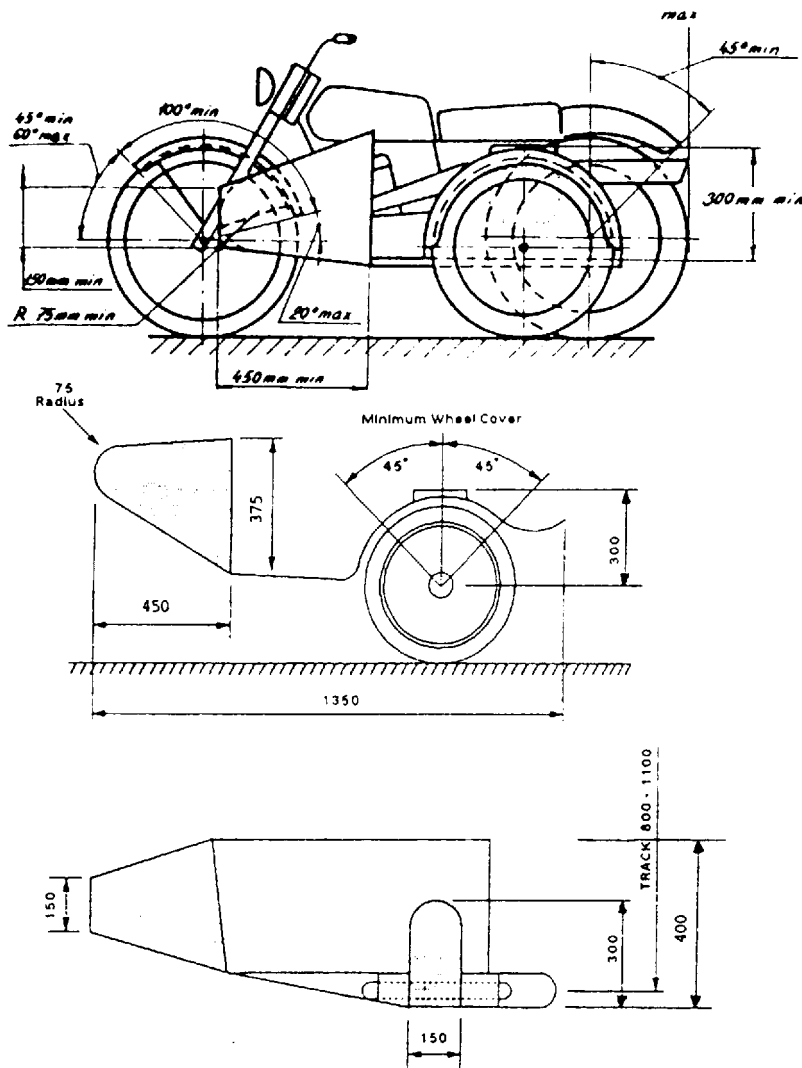

- (a) The entire body including the floor shall be either sheet metal or other substantial material.
- (b) Minimum dimensions will be:-
 - (1) Overall length nose to tail – 1350mm (54 inches)
 - (2) Overall width of cockpit at seating position . 300mm (12 inches)
 - (3) Width of body at forward end – 150mm (6 inches)
 - (4) Depth of body at forward end – 150mm (6 inches)
or if the forward end is spherical and radius shall not be less than 75mm (3 inches)
 - (5) The height of the body at the apex of the dashboard position - 375mm (15 inches)
 - (6) Measurement from nose to dashboard - 450mm (18 inches)
- (c) A padded seat measuring not less than 300mm (12 inches) wide x 150mm (6 inches) must be fitted
The height of the seat shall not be less than - 300mm (12 inches) from the floor of the sidecar
The overall distance between the outside of the sidecar mudguard or bodywork and the inside of the passenger seat measured at right angles to the machine track - 400mm (16 inches)
- (d) The fitting of grab rails, handles, straps etc ;, shall be according to the drivers requirements
- (e) Protection for the passenger must be provided from the rear wheel, the primary and final drive of the motor cycle and from the sidecar wheel, by means of either a mudguard or the coachwork of the sidecar
- (f) The use of sidecar wheel drive is prohibited.



UNLESS OTHERWISE STATED
ALL DIMENSIONS ARE MINIMUM